

I-259 / I-359 PARTS LIST

Aerio Q60

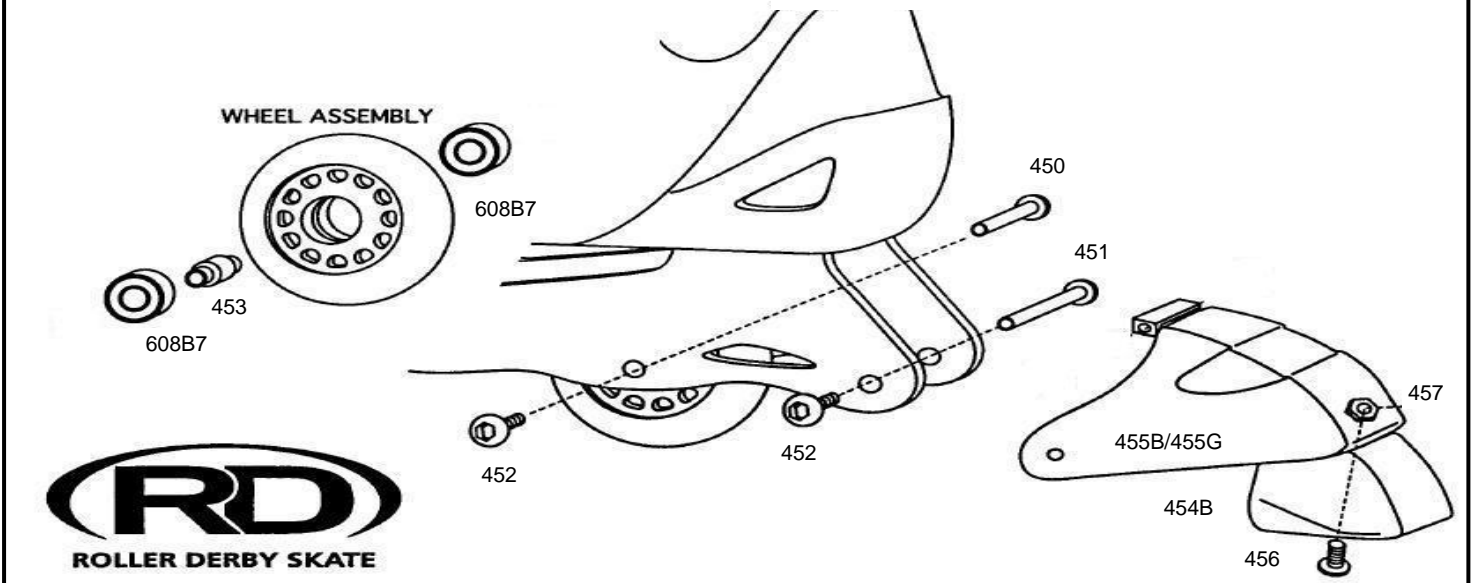

Part #	Description	Cost	Qty	Total	Part #	Description	Cost	Qty	Total
450	Female Axle 27mm	\$0.40			455B	Heel Stop Bracket Black	\$1.75		
451	Female Axle 36mm (Brake)	\$0.40			455G	Heel Stop Bracket Grey	\$1.75		
452	Male Axle Screw 13mm	\$0.40			454B	Heel Stop - Black	\$1.50		
453	Bearing Spacer	\$0.40			456	Heel Stop Screw 27mm	\$0.40		
608B7	Bearing - ABEC 7	\$2.50			457	Heel Stop Locknut	\$0.20		
BR8082BB	Wheel - 80mm Black	\$5.00			3359	Clip - Black	\$0.50		
BR8082WB	Wheel - 80mm White	\$5.00			3259B	Strap/Lever - Black	\$1.50		
					3259G	Strap/Lever - Grey	\$1.50		

All orders must be paid by check, Visa, or Mastercard prior to shipment

All orders are required to be faxed or mailed with signature

CA residents add 8% tax
 IL residents add 6.75% tax
 PA residents add 6% tax

Subtotal	
Tax	
Shipping and Handling	\$6.25
TOTAL	

Name: _____ Signature: _____ Phone: _____

Address: _____ City: _____ State: _____ Zip: _____

MC or Visa #: _____ Exp Date: _____

1. Check the axle screws on each wheel. The male and female should be tightened firmly prior to each use.
2. Check heel stop screw before skating. The male and female should be tightened firmly. If heel stop shows substantial wear, it should be replaced.

1. Prüfen sie die schrauben aller rollen, schraube und mutter vor gebrauch gut festdrehen.
2. Prüfen sie die schraube beim stopper bevor sie fahren. Schraube und mutter gut befestigen. Ersetzen sie den stopper, wenn er abgenutzt ist.

1. Sur chaque roue, vérifiez les vis de l'essieu. Les vis mâles et femelles doivent être serrées fermement avant l'utilisation des patins.
2. Vérifiez les vis du frein avant l'utilisation des patins. Les vis mâles et femelles doivent être serrées fermement. Si le frein arrière montre des signes apparents d'usure. Veuillez le remplacer.

1. Cheque los tornillos de cada rueda, macho y hembra de los tornillos deberan apretarse antes de cada uso.
2. Cheque todos los tornillos del freno para asegurarse que esten bien apretados. Si nota que la goma del freno esta gastada, esta debera ser reemplazada por una nueva