

I-243 / I-343 PARTS LIST

PROLINE 900

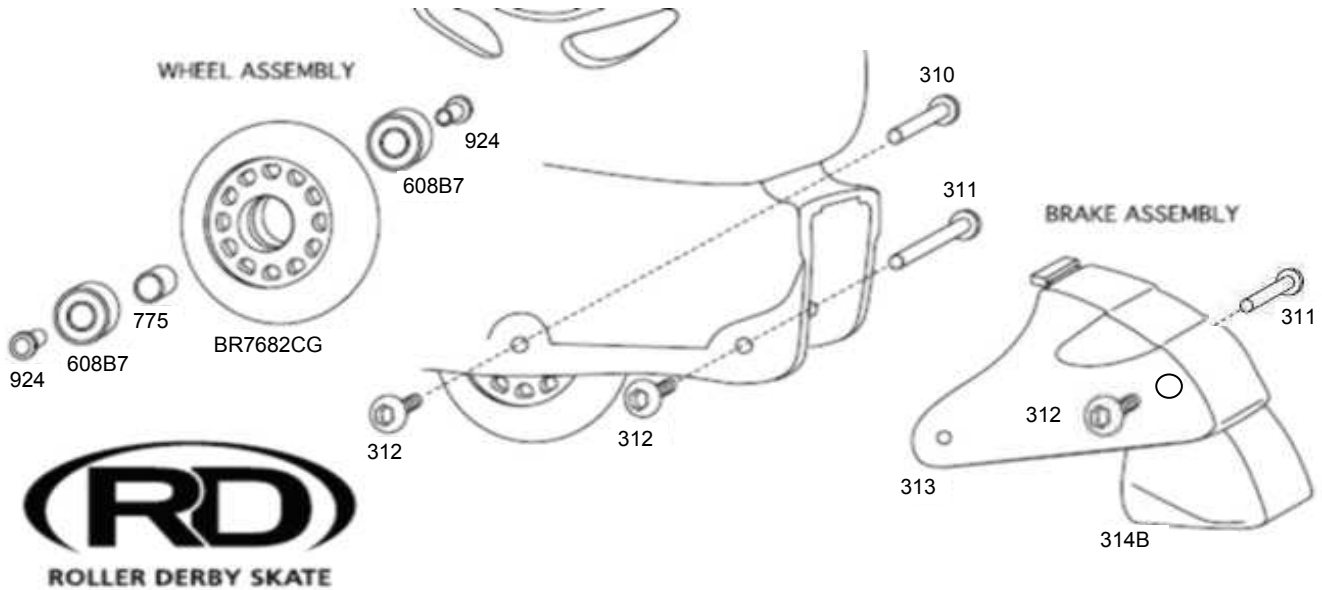

Part #	Description	Cost	Qty	Total	Part #	Description	Cost	Qty	Total
310	Female Axle 34mm	\$0.40			314B	Heel Stop - Black	\$1.50		
311	Female Axle 40mm (Brake)	\$0.40			313	Heel Stop Bracket	\$1.50		
312	Male Axle Screw 10mm	\$0.40			3243L	Left Strap/Lever - Blk/Slvr	\$1.50		
312	Male Axle 10mm (Brake)	\$0.40			3243R	Right Strap/Lever - Blk/Slvr	\$1.50		
924	Bearing Alignment Insert	\$0.40			3342	Clip - Black	\$1.00		
775	Bearing Spacer	\$0.20			2143	Liner - Men's (Specify sz)	\$10.00		
608B7	Bearing - ABEC 7	\$2.50			2343	Liner - Wmn's (Specify sz)	\$10.00		
					BR7682CG	Wheel - Elite Clr/Grn	\$4.00		

All orders must be paid by check, Visa, or Mastercard prior to shipment

All orders are required to be faxed or mailed with signature

CA residents add 8% tax
 IL residents add 7.25% tax
 PA residents add 6% tax

Subtotal	
Tax	
Shipping and Handling	\$6.25
TOTAL	

Name: _____ Signature: _____ Phone: _____

Address: _____ City: _____ State: _____ Zip: _____

MC or Visa #: _____ Exp Date: _____

1. Check the axle screws on each wheel. The male and female should be tightened firmly prior to each use.
 2. Check heel stop screw before skating. The male and female should be tightened firmly. If heel stop shows substantial wear, it should be replaced.
-
1. Sur chaque roue, vérifiez les vis de l'essieu. Les vis mâles et femelles doivent être serrées fermement avant l'utilisation des patins.
 2. Vérifiez les vis du frein avant l'utilisation des patins. Les vis mâles et femelles doivent être serrées fermement. Si le frein arrière montre des signes apparents d'usure. Veuillez le remplacer.

1. Prüfen sie die schrauben aller rollen, schraube und mutter vor gebrauch gut festdrehen.
 2. Prüfen sie die schraube beim stopper bevor sie fahren. Schraube und mutter gut befestigen. Ersetzen sie den stopper, wenn er abgenutzt ist.
-
1. Cheque los tornillos de cada rueda, macho y hembra de los tornillos deberan apretarse antes de cada uso.
 2. Cheque todos los tornillos del freno para asegurarse que esten bien apretados. Si nota que la goma del freno esta gastada, esta debera ser reemplazada por una nueva