

I-144B/I-144G PARTS LIST

Stingray Adjustable

Small 12-2
Medium 3-6

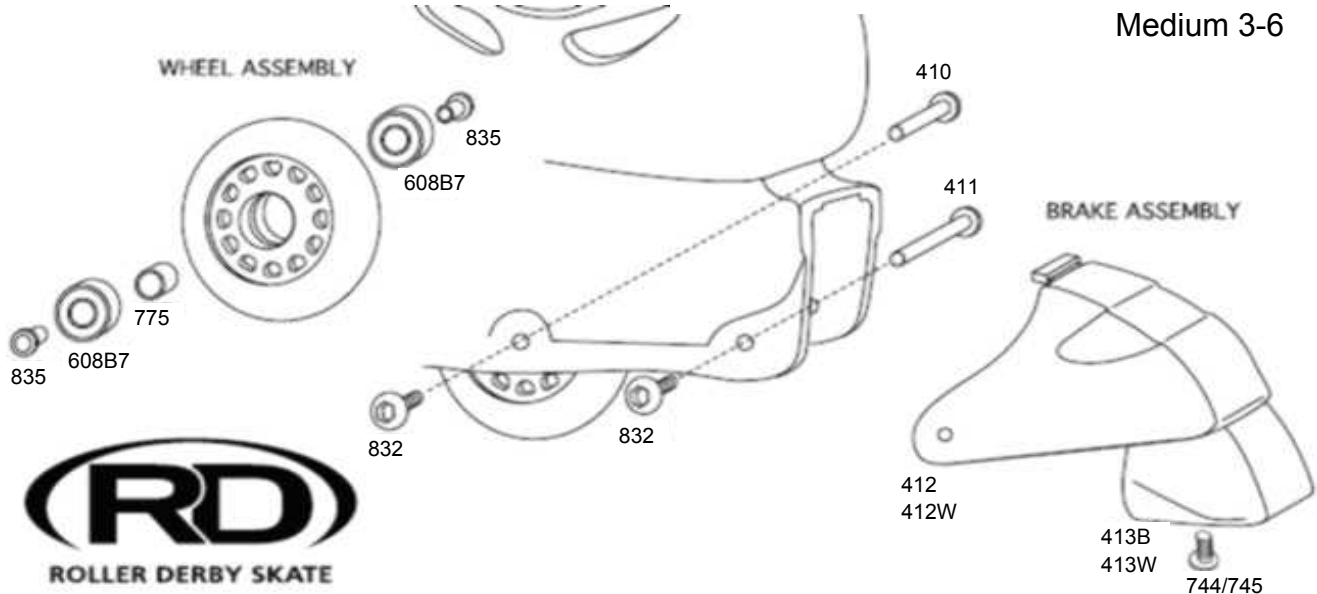

Part #	Description	Cost	Qty	Total	Part #	Description	Cost	Qty	Total
410	Female Axle	\$0.40			BF7282P	Wheel - 72mm Purple	\$6.00		
832	Male Axle Screw	\$0.40			3244O	Strap/Lever Orange/Grey	\$1.50		
835	Bearing Alignment Insert	\$0.40			3244P	Strap/Lever Purple/White	\$1.50		
775	Bearing Spacer	\$0.20			413W	Heel Stop - White	\$1.50		
608B7	Bearing - Rated 7	\$2.50			412W	Heel Stop Bracket White	\$1.50		
744/745	Male Heel Stop Screw	\$0.40			413B	Heel Stop - Black	\$1.50		
411	Female Axle (Brake)	\$0.40			412	Heel Stop Bracket Black	\$1.50		
BF72820	Wheel - 72mm Orange	\$6.00							

All orders must be paid by check, Visa, or Mastercard prior to shipment
All orders are required to be faxed or mailed with signature

CA residents add 8% tax
IL residents add 7.25% tax
PA residents add 6% tax

Subtotal	
Tax	
Shipping and Handling	\$6.25
TOTAL	

Name: _____ Signature: _____ Phone: _____

Address: _____ City: _____ State: _____ Zip: _____

MC or Visa #: _____ Exp Date: _____

1. Check the axle screws on each wheel. The male and female should be tightened firmly prior to each use.
2. Check heel stop screw before skating. The male and female should be tightened firmly. If heel stop shows substantial wear, it should be replaced.

1. Prüfen sie die schrauben aller rollen, schraube und mutter vor gebrauch gut festdrehen.
2. Prüfen sie die schraube beim stopper bevor sie fahren. Schraube und mutter gut befestigen. Ersetzen sie den stopper, wenn er abgenutzt ist.

1. Sur chaque roue, vérifiez les vis de l'essieu. Les vis mâles et femelles doivent être serrées fermement avant l'utilisation des patins.
2. Vérifiez les vis du frein avant l'utilisation des patins. Les vis mâles et femelles doivent être serrées fermement. Si le frein arrière montre des signes apparents d'usure. Veuillez le remplacer.

1. Cheque los tornillos de cada rueda, macho y hembra de los tornillos deberan apretarse antes de cada uso.
2. Cheque todos los tornillos del freno para asegurarse que esten bien apretados. Si nota que la goma del freno esta gastada, esta debera ser reemplazada por una nueva