

# I-130 PARTS LIST

# GTS 200

## ADJUSTABLE

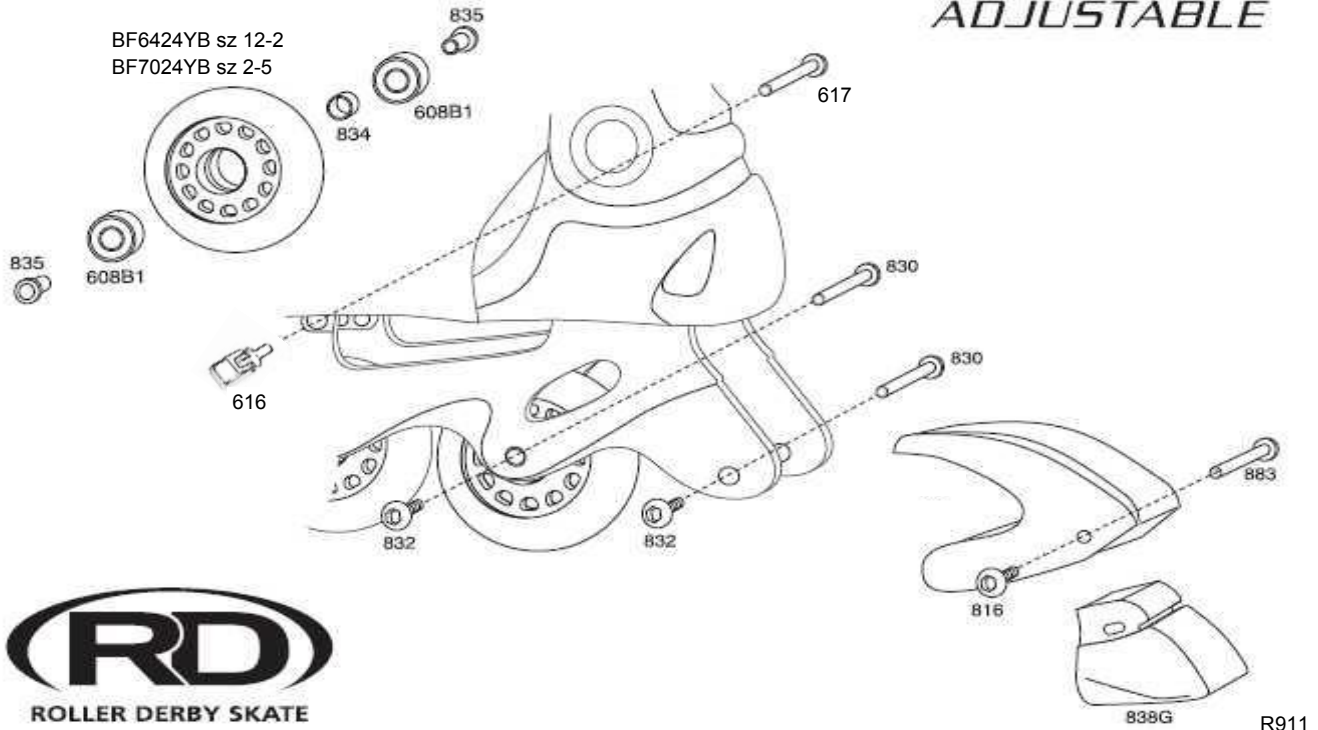

R911

Part #	Description	Cost	Qty	Total	Part #	Description	Cost	Qty	Total
830	35mm Female Axle	\$0.40			BF6424YB	Wheel - 64mm sz 12-2	\$2.50		
832	10mm Male Axle Screw	\$0.40			BF7024YB	Wheel - 70mm sz 2-5	\$3.00		
616	Male Sz Adj Screw	\$0.40			3230L	Strap/Lever - Left	\$1.50		
617	Female Sz Adj Screw	\$0.40			3230R	Strap/Lever - Right	\$1.50		
835	Bearing Alignment Insert	\$0.20			3330	Clip - Blue	\$0.50		
608B1	Bearing - ABEC 1	\$1.00			883	35mm Female Heel Stop Screw	\$0.40		
834	Bearing Spacer	\$0.20			816	7mm Male Heel Stop Screw	\$0.40		
838G	Heel Stop - Gray	\$2.50							

All orders must be paid by check, Visa, or Mastercard prior to shipment  
 All orders are required to be faxed or mailed with signature

CA residents add 8% tax  
 IL residents add 7.25% tax  
 PA residents add 6% tax

Subtotal	
Tax	
Shipping and Handling	\$6.25
<b>TOTAL</b>	

Name: \_\_\_\_\_ Signature: \_\_\_\_\_ Phone: \_\_\_\_\_

Address: \_\_\_\_\_ City: \_\_\_\_\_ State: \_\_\_\_\_ Zip: \_\_\_\_\_

MC or Visa #: \_\_\_\_\_ Exp Date: \_\_\_\_\_

Please include Security Code from back of card.

1. Check the axle screws on each wheel. The male and female should be tightened firmly prior to each use.
2. Check heel stop screw before skating. The male and female should be tightened firmly. If heel stop shows substantial wear, it should be replaced.

1. Prüfen sie die schrauben aller rollen, schraube und mutter vor gebrauch gut festdrehen.
2. Prüfen sie die schraube beim stopper bevor sie fahren. Schraube und mutter gut befestigen. Ersetzen sie den stopper, wenn er abgenutzt ist.

1. Sur chaque roue, vérifiez les vis de l'essieu. Les vis mâles et femelles doivent être serrées fermement avant l'utilisation des patins.
2. Vérifiez les vis du frein avant l'utilisation des patins. Les vis mâles et femelles doivent être serrées fermement. Si le frein arrière montre des signes apparents d'usure. Veuillez le remplacer.

1. Cheque los tornillos de cada rueda, macho y hembra de los tornillos deberan apretarse antes de cada uso.
2. Cheque todos los tornillos del freno para asegurarse que esten bien apretados. Si nota que la goma del freno esta gastada, esta debera ser reemplazada por una nueva